

(A) WALL TYPE A

SCALE: 3" = 1'-0"

FIRE NUMBER: UL DES U419 OR U453 (A23)

STC NUMBER: RAL-TL-87-140 (A23)

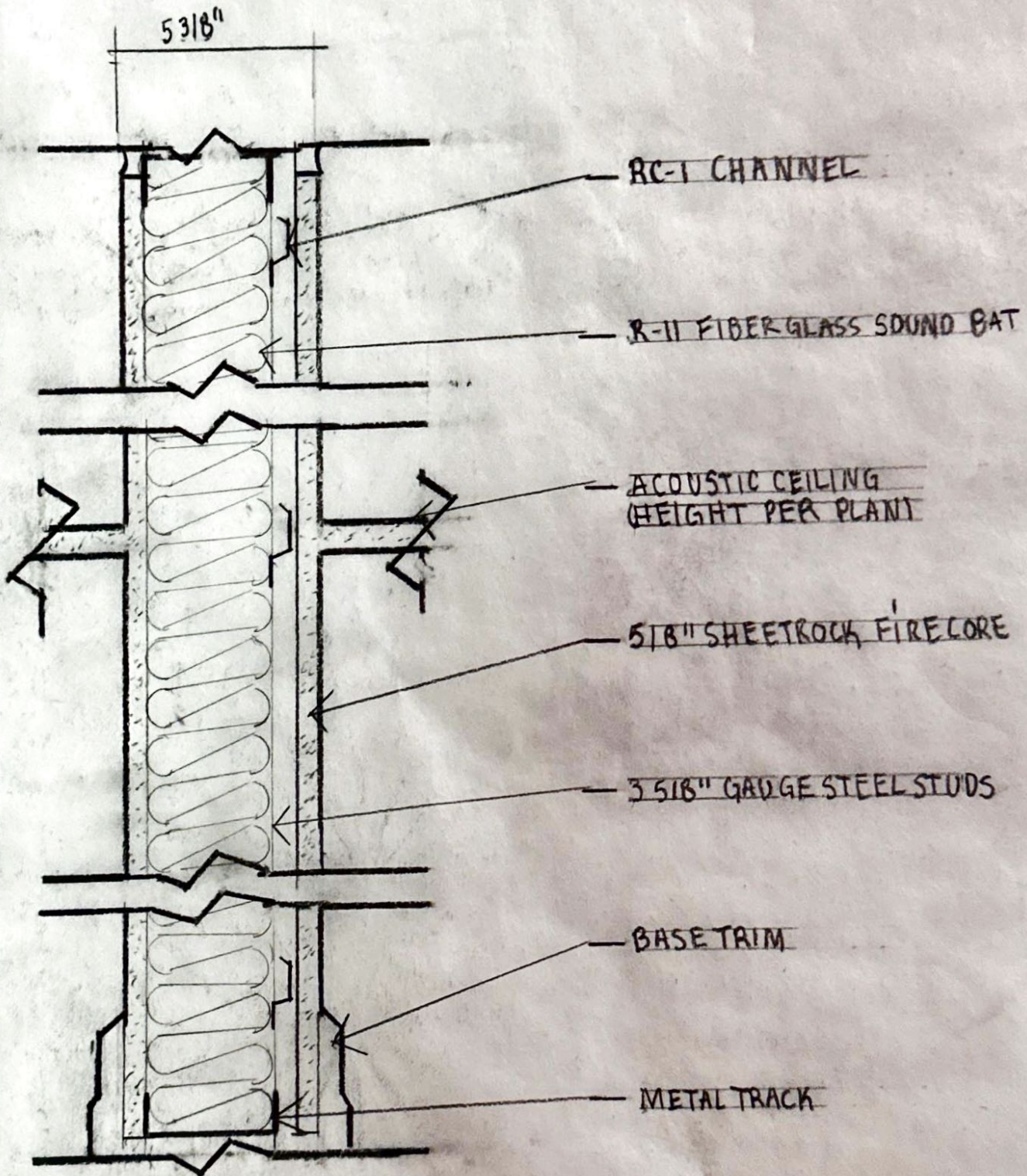

**B** WALL TYPE B  
 SCALE: 3" = 1'-0"

FIRE NUMBER: ULDES U419  
 STC NUMBER: RAL-TL-11-076 (A2)

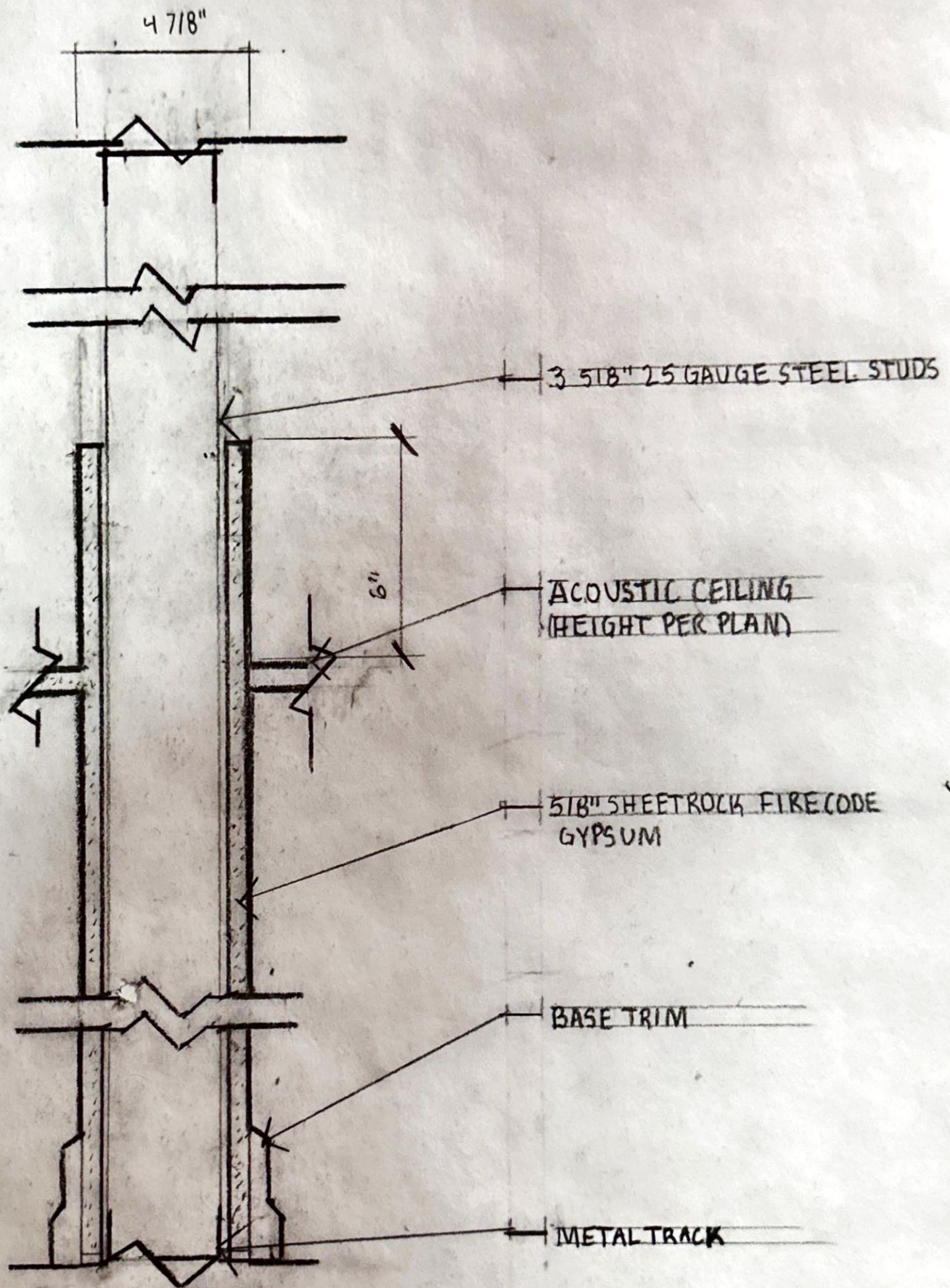

4 7/8"

3 5/8" 25 GAUGE STEEL STUDS

6"  
ACOUSTIC CEILING  
(HEIGHT PER PLAN)

5/8" SHEETROCK FIRE CODE  
GYPSUM

BASE TRIM

METAL TRACK

D

WALL TYPED

SCALE: 3" = 1'-0"

FIRE NUMBER: UL DES U419 (A2)

STC NUMBER: U5G-860808 (A2)

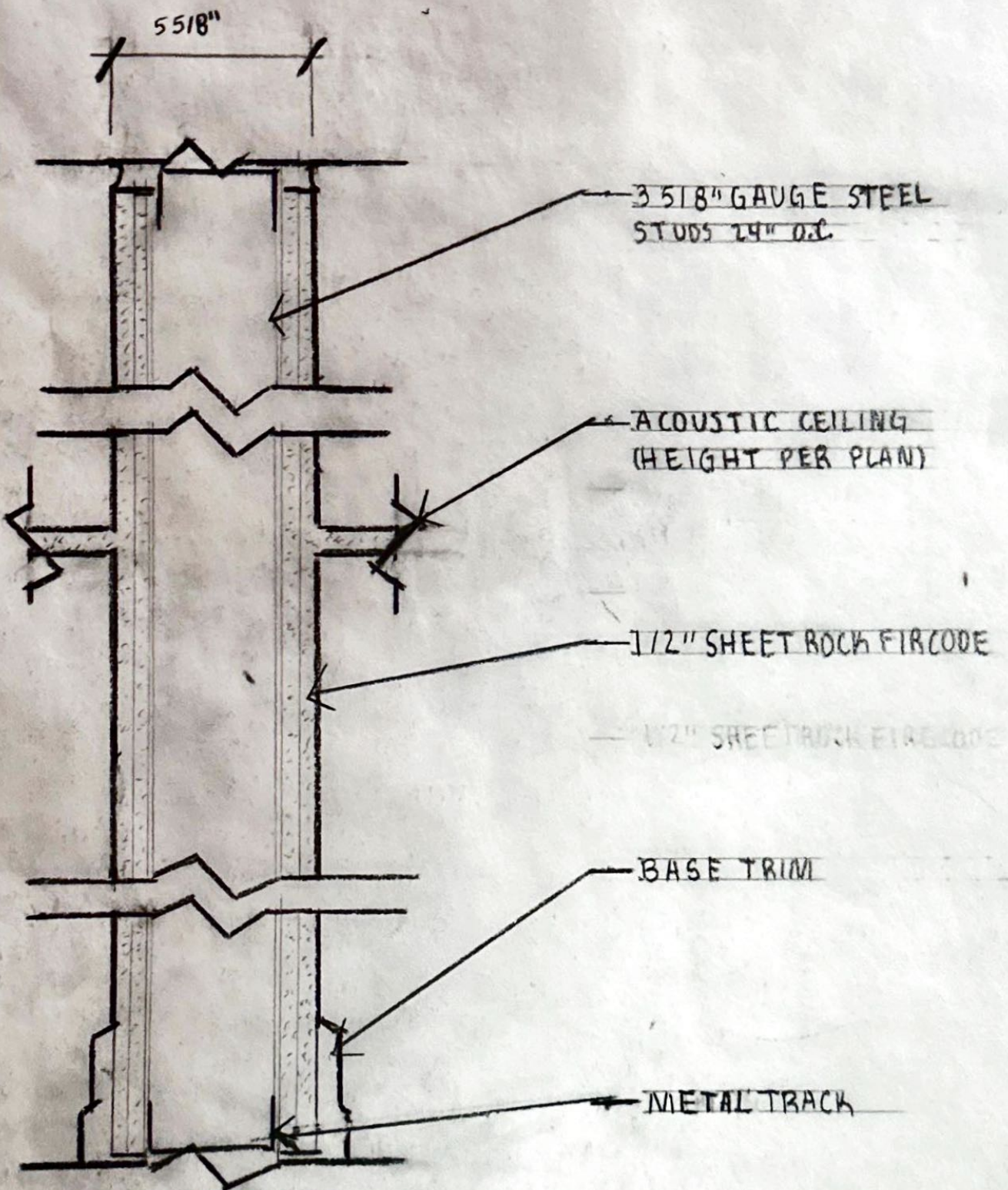

(C)

WALL TYPE C

SCALE: 3" = 1'-0"

FIRE NUMBER: UL DES U419 OR U412 (A19)

STC NUMBER: USG-840817 (A19)